

0  
1  
2  
3  
4  
5  
6  
7  
8  
9  
10  
11  
12  
13  
14  
15  
16  
17  
18  
19  
20



## MONTAGEANLEITUNG



**Meeth**  
FENSTER UND TÜREN

### Schiebetüren

Stand: 10/2018

[www.meeth.de](http://www.meeth.de)



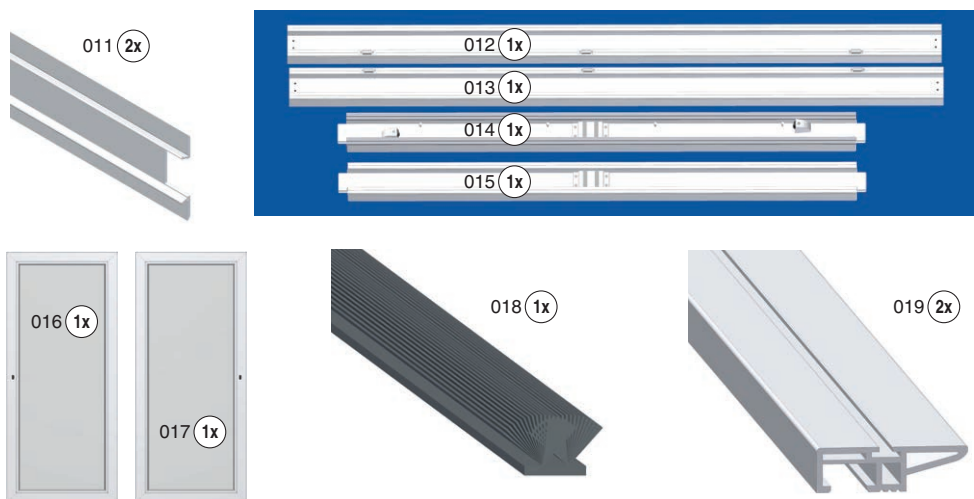
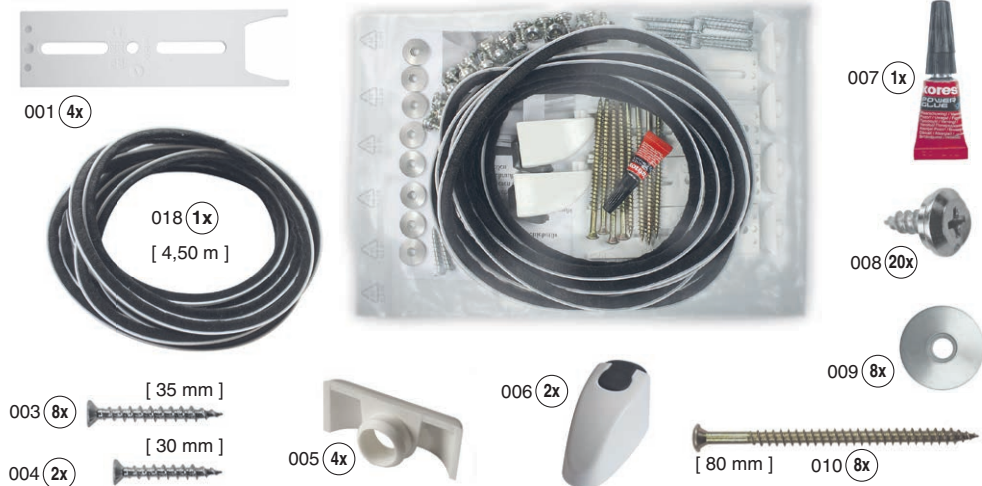
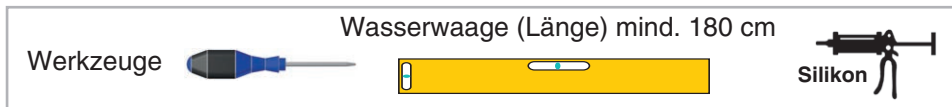
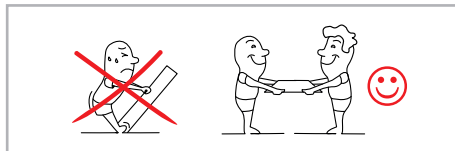
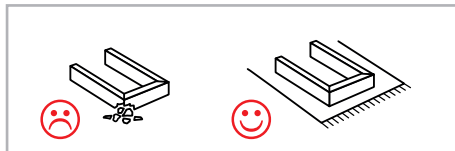

01

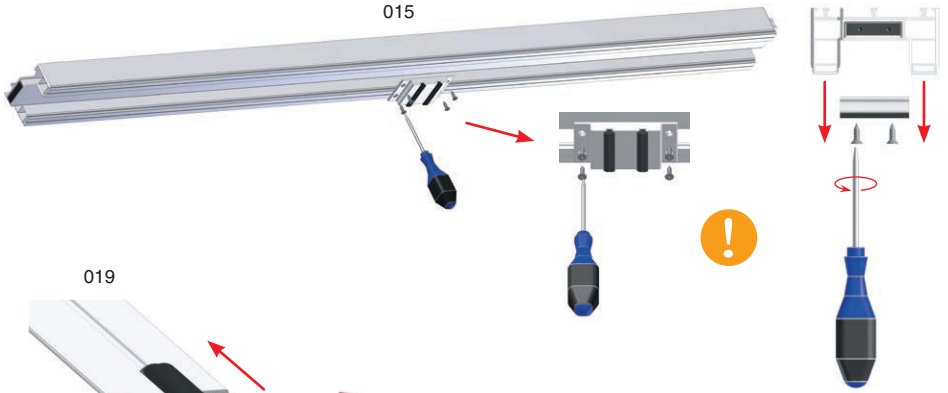

02

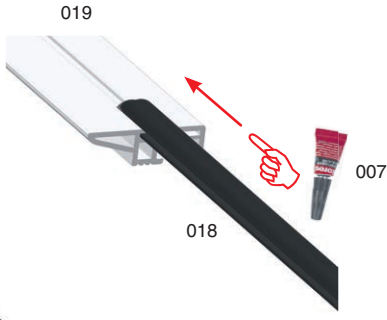

03

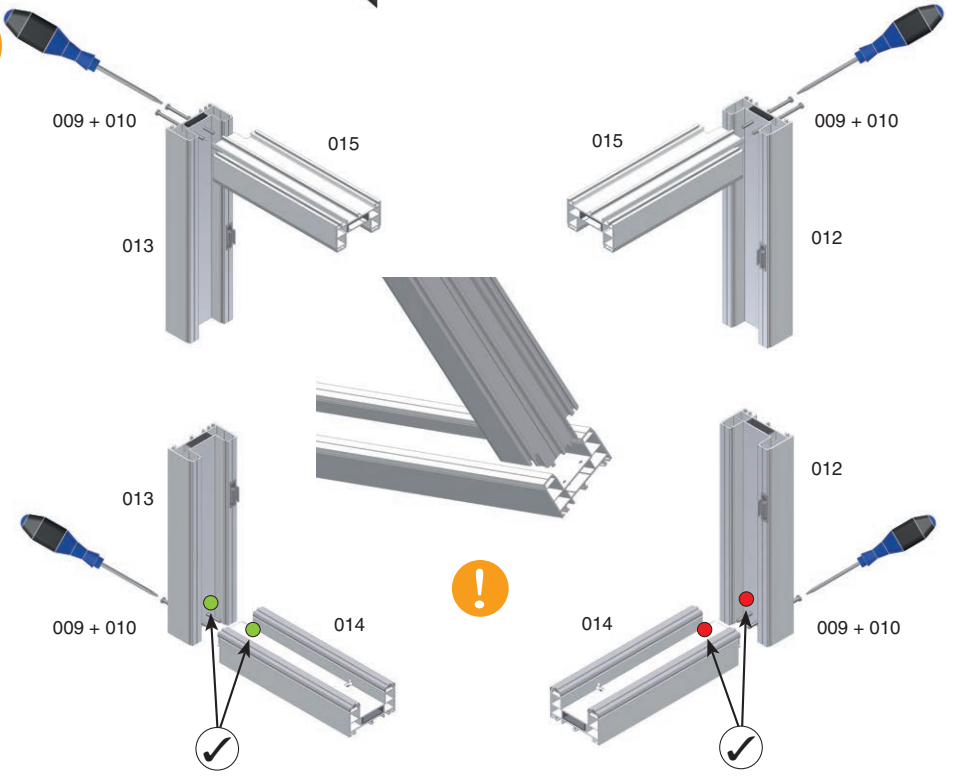

04

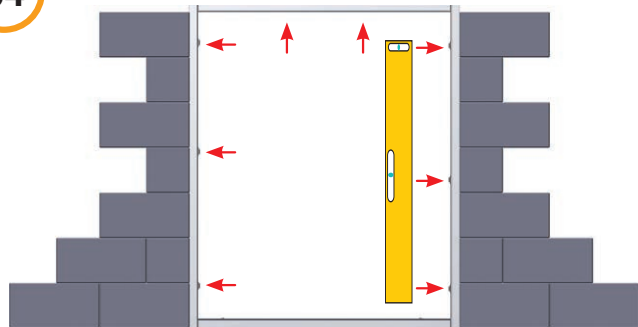

Wasserwaage (Länge) mind. 180 cm

Montagehilfe:  
3 Stützleisten

**A = B = C**

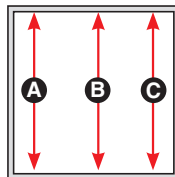

Diagonale  
Vermessung

**d1 = d2**

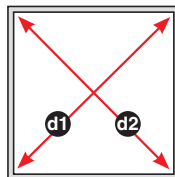

05



06

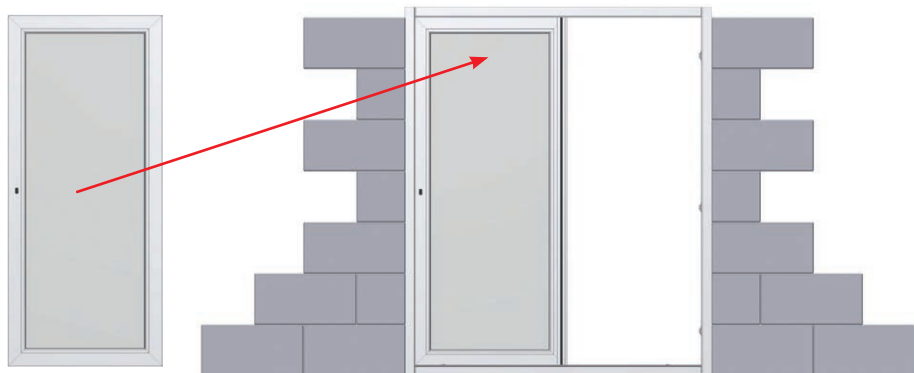

07

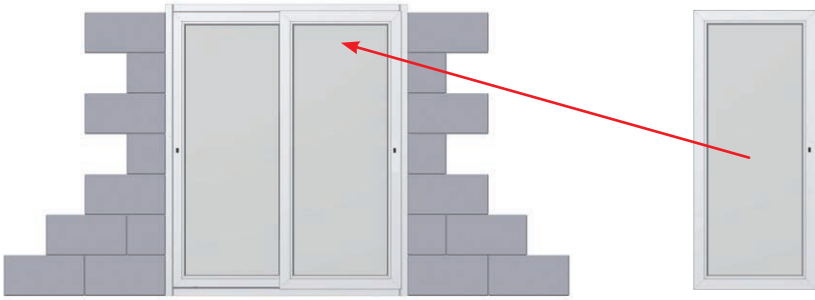

08



AUSHEBESICHERUNGEN: A) Höhe 1,90 m = 2 Stück montieren B) Höhe größer als 1,90 m = 4 Stück montieren

09

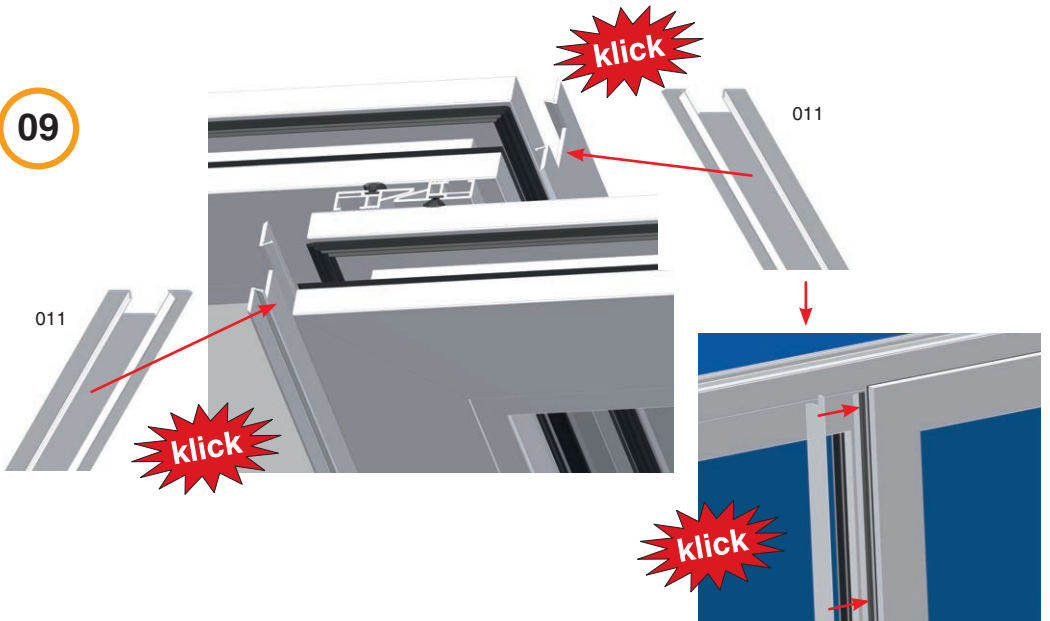

10

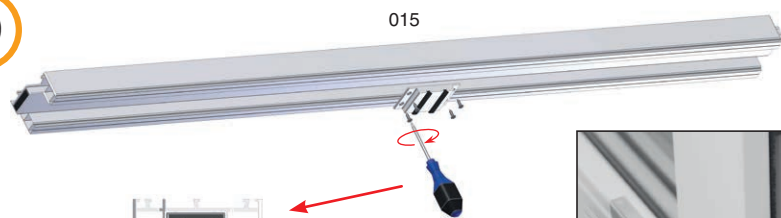

Empfohlener Überschlag  
oben und unten ca. 1 cm!

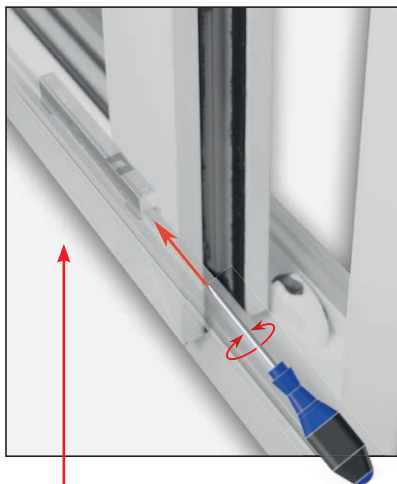

Höheneinstellung der Laufwagen im  
Schiebeelement-Flügel mit Hilfe eines  
Schraubendrehers (Größe PZ2).

Im Uhrzeigersinn = hoch ▲  
Gegen den Uhrzeigersinn = runter ▼

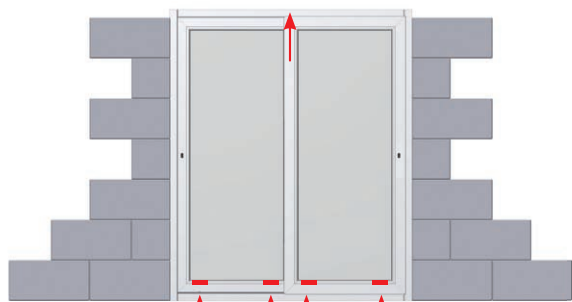

1 2 3 4 = Positionen der 4 Laufwagen



11

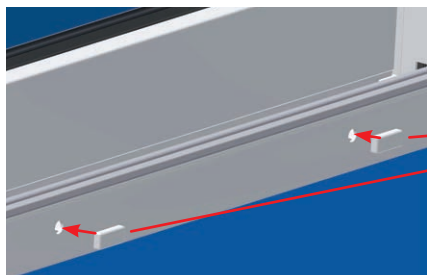

005



12

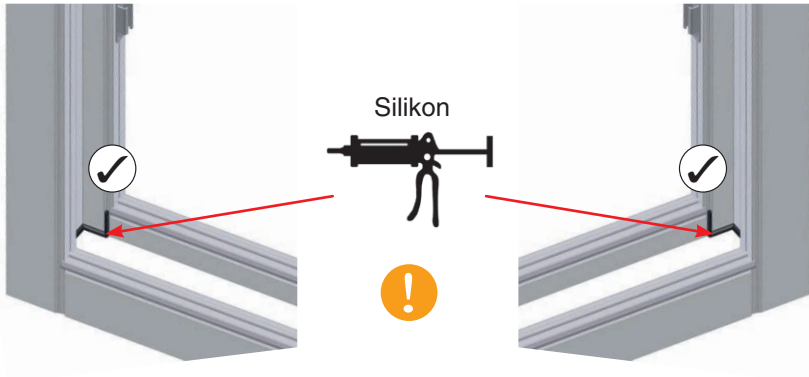

### Stopper Einbau



Stopper positionieren (006)



Stopper einsetzen



Gummiabdeckung **nur anheben**



Schrauben positionieren (004)



Stopper mit Schraube befestigen



Gummiabdeckung schließen



Die neue **Meeth App** jetzt kostenlos downloaden:



Josef Meeth Fensterfabrik GmbH & Co. KG  
54533 Laufeld ▪ Telefon: 06572 / 81-0 ▪ [www.meeth.de](http://www.meeth.de)